

**DIODE ACTION = 0.5 E<sup>6</sup>I<sup>2</sup>Sec**

**VRE-3005      5 KV**

**VRE-3010      10 KV**

**VRE-3015      15 KV**

**DIODE ACTION = 1.9 E<sup>6</sup>I<sup>2</sup>Sec**

**VRE-5005      5 KV**

**VRE-5010      10 KV**

**VRE-5015      15 KV**

**Plus : unlimited series without external components**

**Plus : unlimited parallel without additional matching**

**VR ELECTRONICS CO. LTD**  
**HALF SINE Action**

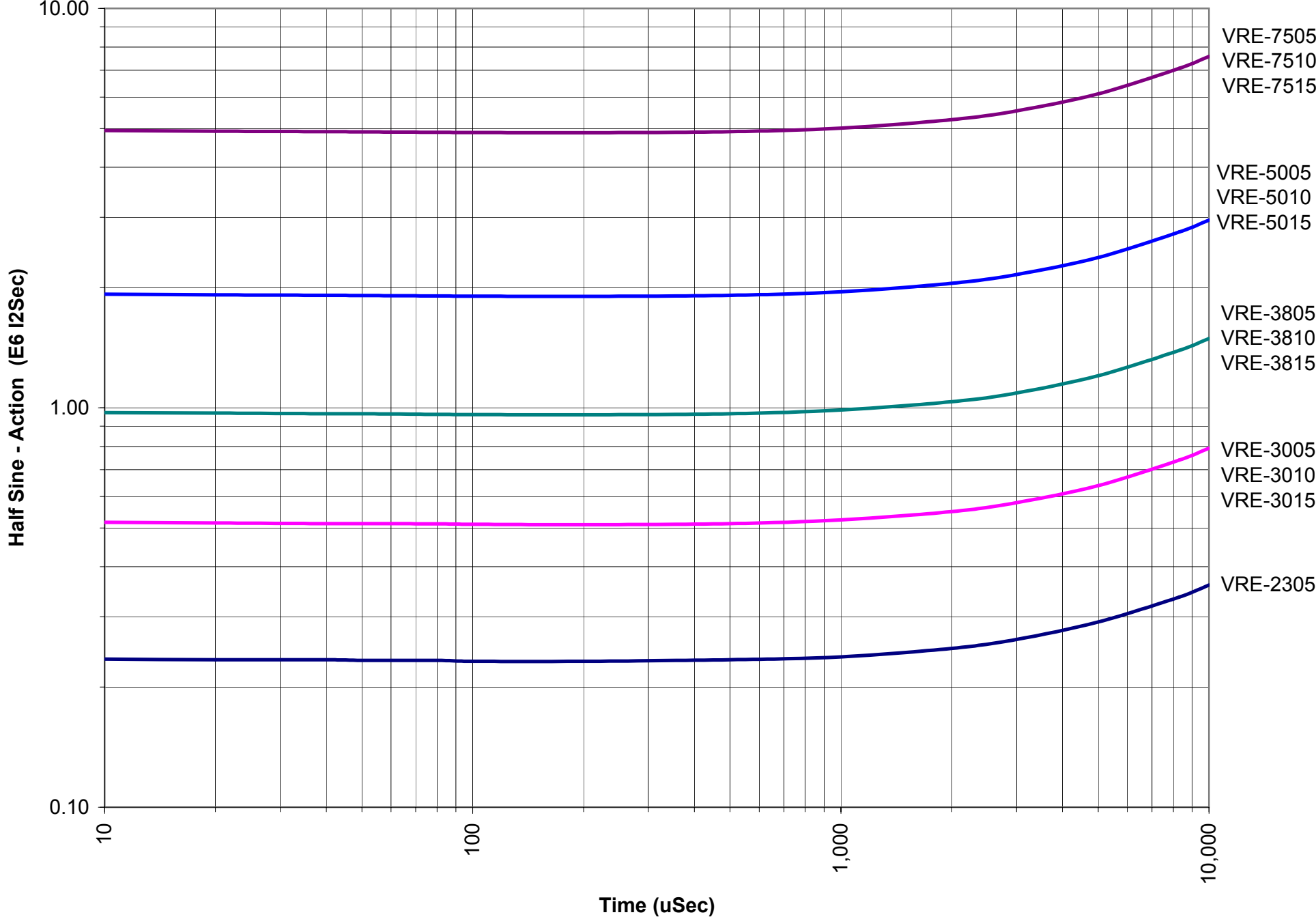

**VR ELECTRONICS CO. LTD**  
**HALF SINE Peak Current**

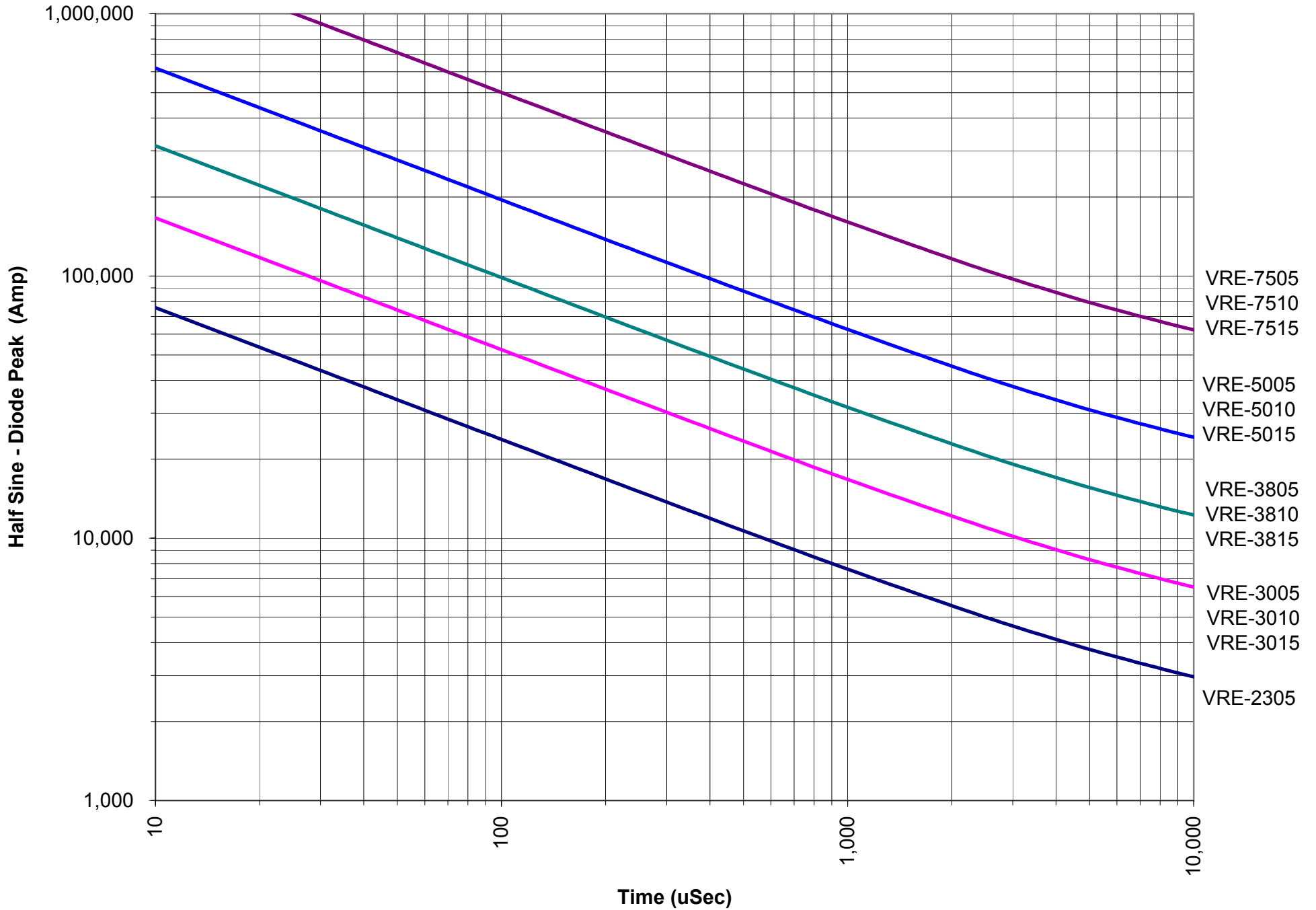

VR ELECTRONICS CO. LTD  
L/R Action

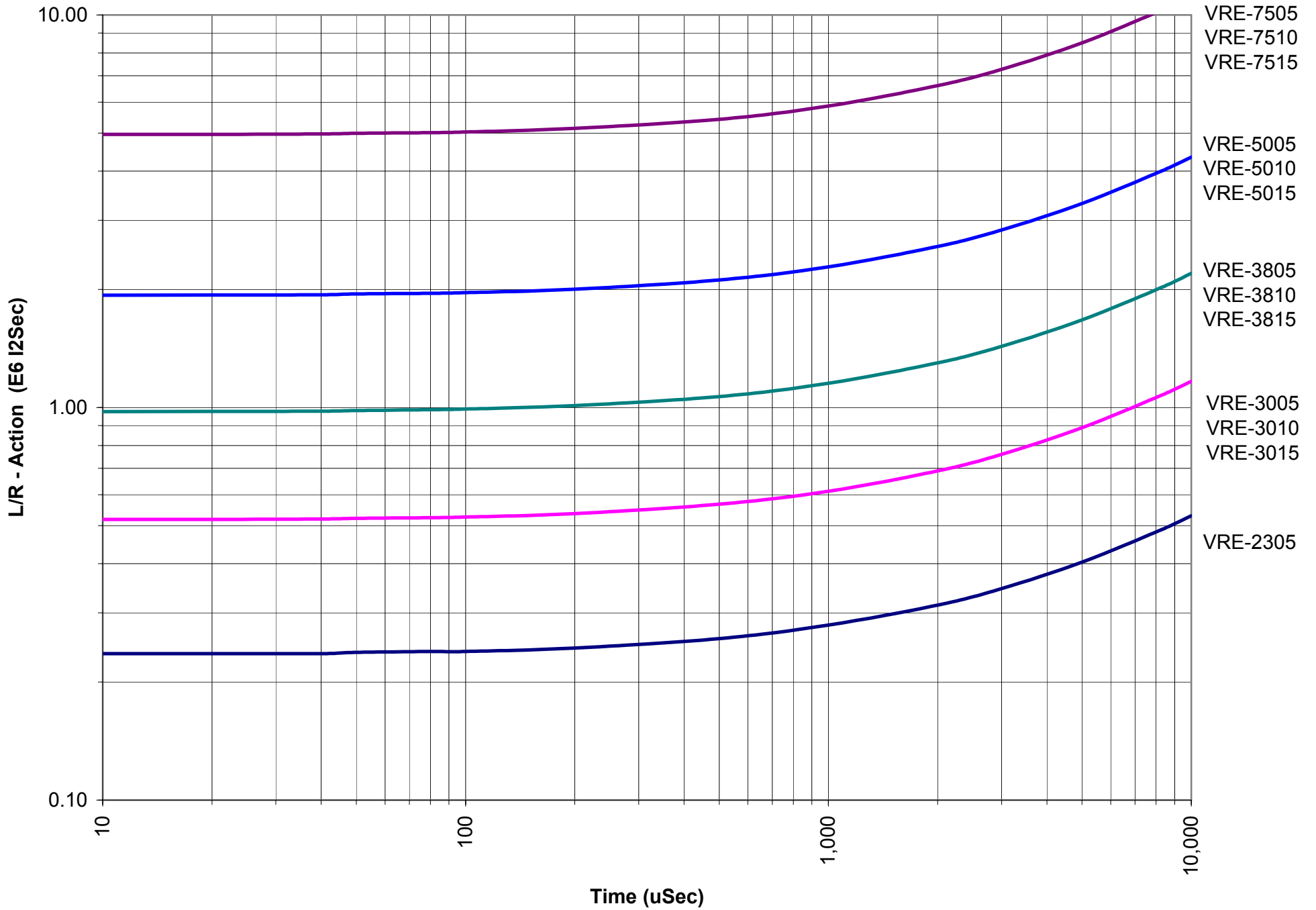

VR ELECTRONICS CO. LTD  
L/R Peak Current

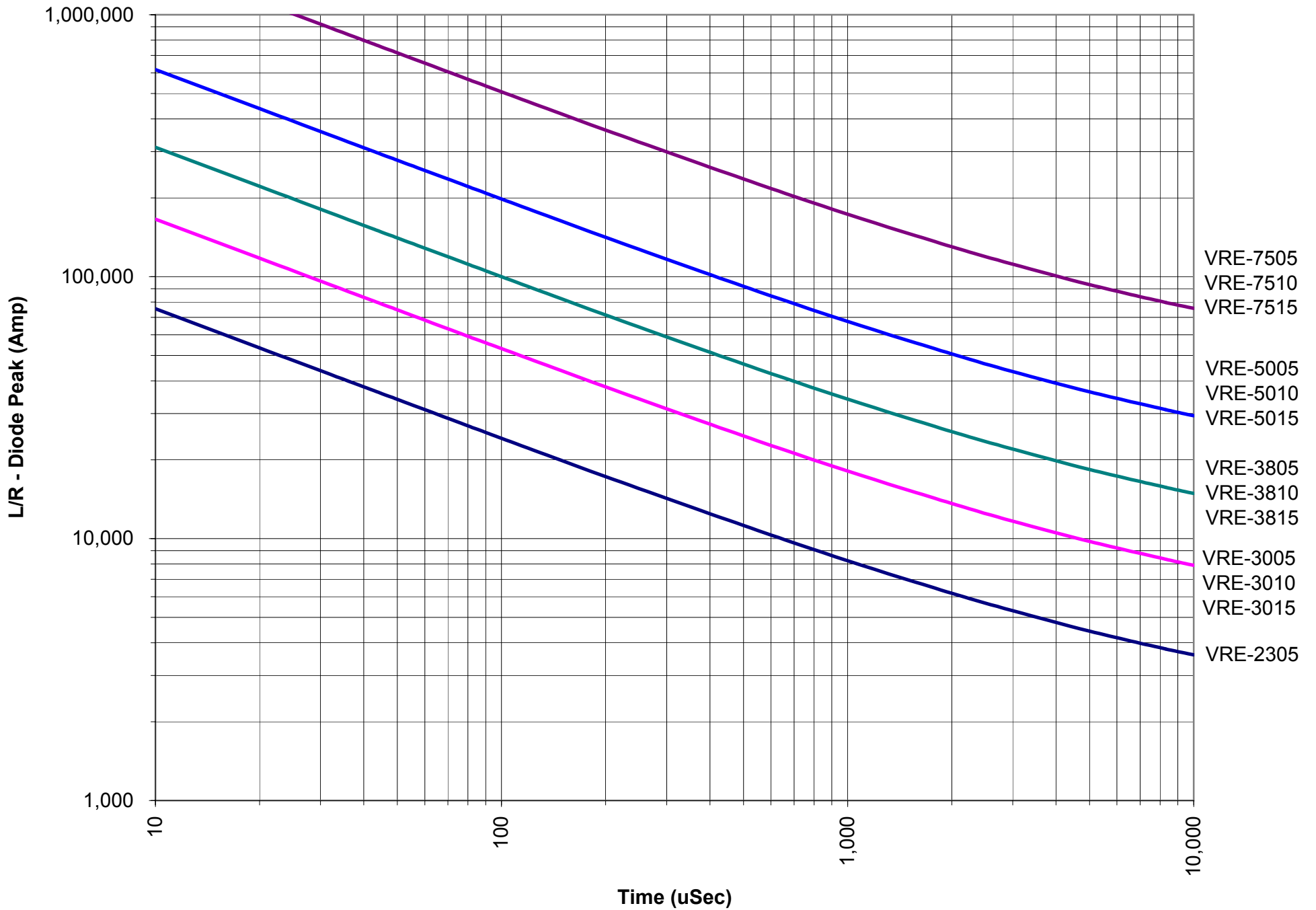

# PACKAGE OUTLINE

VRE-3005 , 5 KV (V<sub>rrm</sub>)

V<sub>rrm</sub> = max peak repetitive and DC voltage

Holes in both electrode pole faces  
Ø3.56 (0.140) x 2.04 (0.080) deep

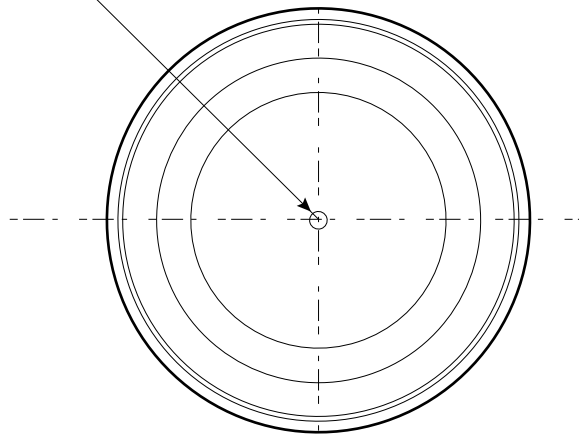

Cathode

Ø42 (1.654) max

Ø25 (0.984) nom.

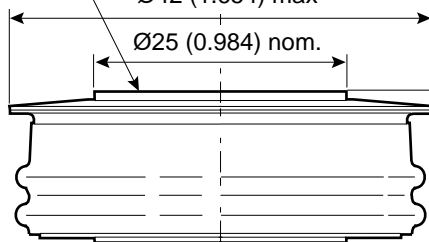

15.37 (0.605)  
14.0 (0.551)



Ø25 (0.984) nom.

Anode

Nominal weight: 85g (0.19 lb)

Clamping force: 8.9 kN (2,000 lb)

All dimensions are in mm (inches)

# PACKAGE OUTLINE

VRE-3010 , 10 KV ( $V_{rrm}$ )

VRE-3015 , 15 KV ( $V_{rrm}$ )

$V_{rrm}$  = max peak repetitive and DC voltage

Holes in both electrode pole faces  
 $\varnothing 3.56$  (0.140) x 2.04 (0.080) deep

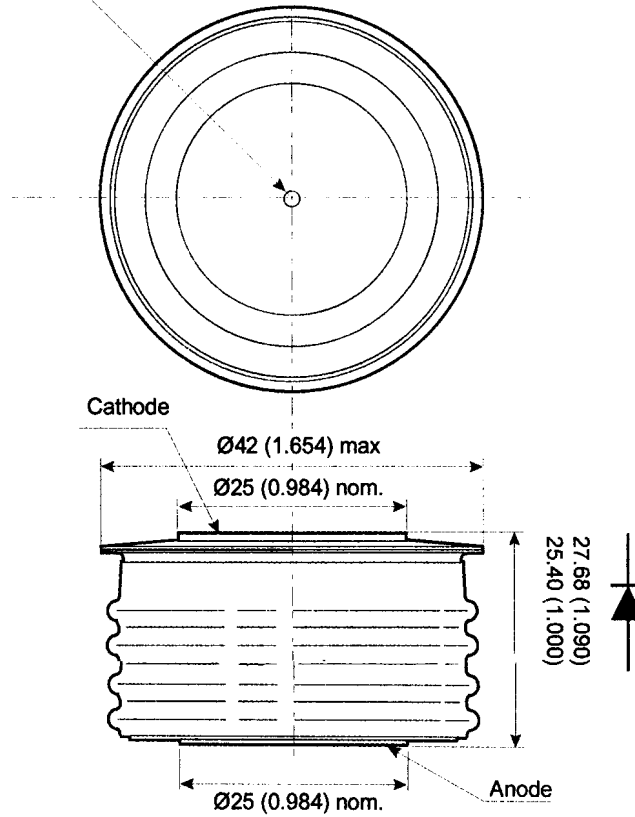

Nominal weight: 155g (0.34 lb)

Clamping force: 8.9 kN (2,000 lb)

All dimensions are in mm (inches)

# PACKAGE OUTLINE

VRE-5005 , 5 KV (V<sub>rrm</sub>)

VRE-5010 , 10 KV (V<sub>rrm</sub>)

VRE-5015 , 15 KV (V<sub>rrm</sub>)

V<sub>rrm</sub> = max peak repetitive and DC voltage

Holes in both electrode pole faces

Ø 3.56 (0.140) x 2.04 (0.080) deep

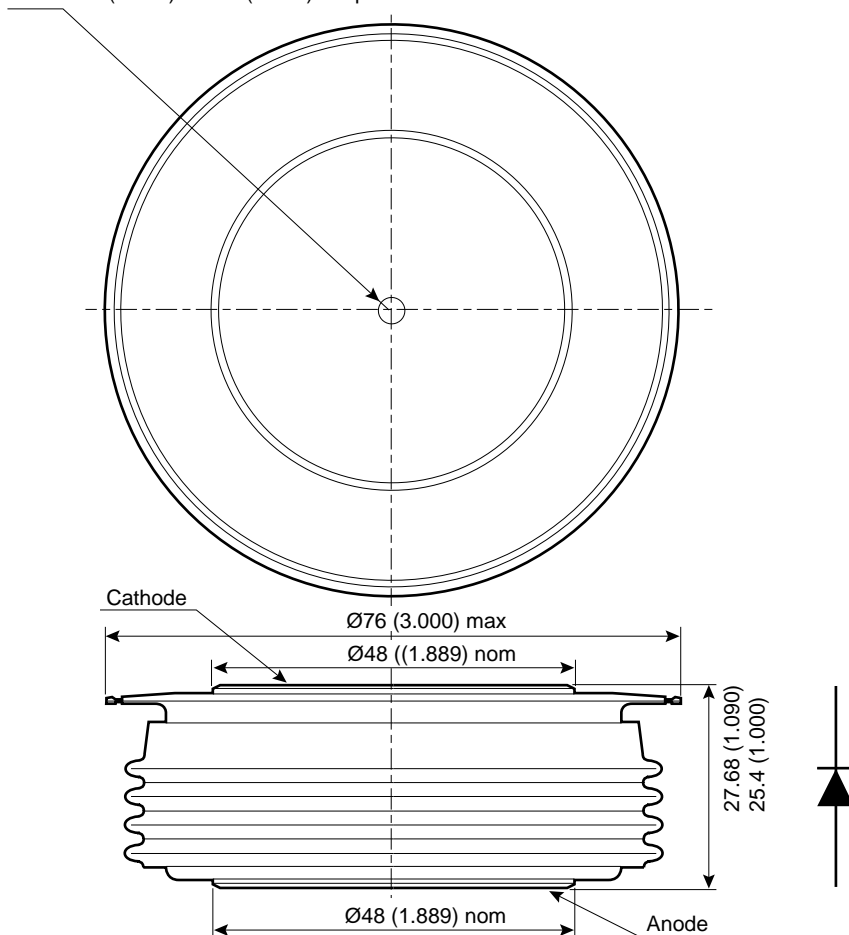

Nominal weight: 485g (1.07 lb)  
Clamping force: 22 kN (5,000 lb) ± 10%

## JEDEC outline DO-200AC

All dimensions in mm (inches)